

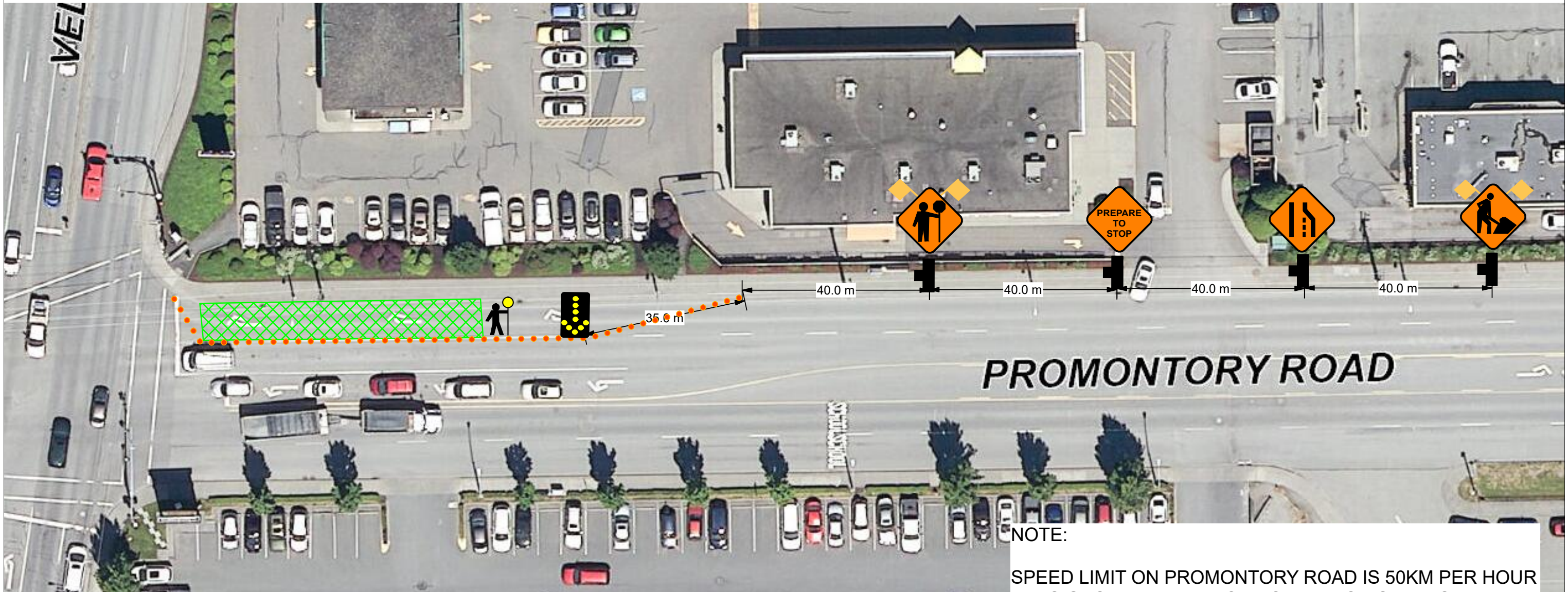

CANADIAN UTILITY CONSTRUCTION  
FORTIS BC GAS WORK - PAVEMENT REPAIR  
PROMONTORY ROAD AT VEDDER ROAD, CHILLIWACK  
JOB# 357 PAVE - 41312625



MAY 2020  
HOURS OF OPERATION FROM \_\_\_\_\_  
WORK WILL TAKE ONE DAY TO COMPLETE



NOTE:

- SPEED LIMIT ON PROMONTORY ROAD IS 50KM PER HOUR
- ALL SIGNS WILL BE PLACED ON TRIPOD STANDS WITH FLAGS
- ALL SIGNS ON ALL SIDE STREETS WILL BE PLACED ON TRIPOD STANDS WITH FLAGS
- ALL SIDEWALKS - CROSSWALK AND BUS STOPS WILL REMAIN OPEN AT ALL TIMES
- TRAFFIC CONTROL WILL ASSIST WITH DRIVEWAYS EFFECTED BY WORK ZONE CLOSURE

LEGEND

- DIRECTION TRAFFIC FLOW
- NORTH MARKER
- TUBULAR MARKERS
- WORK AREA
- SIGN STANDS
- TRAFFIC CONTROLLER
- BUS STOP
- FLASHING ARROW BOARD TRUCK

CANADIAN UTILITY CONSTRUCTION CONTACTS

GENERAL FOREMAN  
TRAVIS MAYER 604-786-4775  
T.MAYER@CUCCORP.COM

TRAFFIC MANAGER  
MICHELLE PARKS 604-313-5769  
M.PARKS@CUCCORP.COM